

PROGRESSIVE[®] ***ELECTRONICS***

INSTRUCTION MANUAL

200GX INDUCTIVE AMPLIFIER WITH ADJUSTABLE VOLUME



SAFETY ALERT SYMBOL

This symbol is used to call your attention to hazards or unsafe practices which could result in an injury or property damage. The signal word, defined below, indicates the severity of the hazard. The message after the signal word provides information for preventing or avoiding the hazard.

DANGER

Immediate hazards which, if not avoided, **WILL** result in severe injury or death.

WARNING

Hazards which, if not avoided, **COULD** result in severe injury or death.

CAUTION

Hazards which, if not avoided, **MAY** result in injury.



! WARNING

Read and understand this material before operating or servicing this equipment. Failure to understand how to safely operate this tool can result in an accident causing serious injury or death.



! WARNING

Electric Shock hazard:

Contact with live circuits can result in severe injury or death.

! CAUTION

- Do not attempt to repair this unit. It contains no user-serviceable parts.
- Do not expose the unit to extreme temperatures or high humidity. See Specifications.

Failure to observe these precautions can result in injury and can damage the instrument.

Introduction

This manual is intended to familiarize personnel with the safe operation and maintenance procedures for the Progressive Electronics 200GX Inductive Amplifier.

Please read this entire manual before operating the tool and keep this manual available to all personnel. Replacement manuals are available upon request at no extra charge.

Safety

Safety is essential in the use and maintenance of Progressive tools and equipment. This instruction manual and any markings on the tool provide information for avoiding hazards and unsafe practices related to the use of this tool. Observe all of the safety information provided.

Description

Progressive's 200GX Inductive Amplifier, when used in conjunction with any Progressive tone generator, allows you to trace and troubleshoot a variety of electrical circuits – communication, alarm/security, automotive, etc. – without piercing the insulation.

Features include:

- Adjustable volume sensitivity control.
- Recessed terminal port for headset connection.
- Recessed POWER button prevents battery drain.
- Conductive plastic carbon-fiber tip prevents accidental shorts when probing wires.

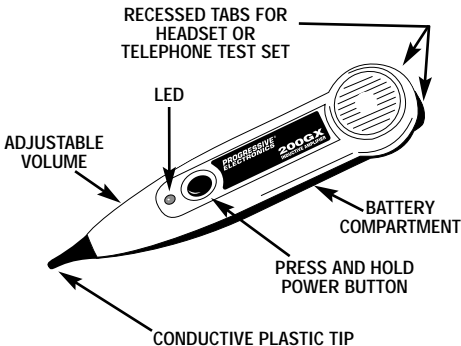

Operation

1. Connect a Progressive tone generator to the wire or circuit to be traced. See the instruction manual provided with the tone generator.
2. To activate the 200GX, press and hold the oval spring-loaded **POWER** button. Hold the tip of the probe near the tone generator and listen for the tone. This verifies that the tone generator is working, and identifies the sound of the tone (steady, warbling, etc.).
3. Once activated, the volume control can be adjusted to suit the environment. Reception can be increased to overcome noise (e.g. vehicular traffic, airplanes or engine room), or decreased to reduce interference (e.g. computer/data hum or AC buzz).
4. Probe each suspect conductor. The strongest reception indicates the wire under test.

Note: To use the 200GX without pressing the **POWER** button, perform either one of the following: (both methods will bypass the speaker and show a visual indication only)

1. Connect a telephone test set (in Talk mode) or headset to the recessed tabs near the speaker.
2. Connect a jumper wire across the two recessed tabs near the speaker.



CAUTION

The recessed tabs are **ONLY** to be used for a telephone test set or a headset.

Specifications

Electrical

Gain	.30 dB
Input Impedance	100 M Ω
Probe Tip Resistance (min):	
Plastic Tip	300 Ω
Battery	One 9 Vdc (NEDA 1604, JIS 006P, or IEC 6LR61)
Battery Life (nominal)	.50 hours

Physical

Length	.229 mm (9.0")
Width	.48 mm (1.875")
Depth	.35 mm (1.375")
Weight	.013 kg (0.29 lbs)

Operating/Storage Conditions

Temperature:	
Celsius	.0°C to 50°C
Fahrenheit	32°F to 122°F
Relative Humidity (max)	.80%
Elevation (max)	.2000 m (6500')

Maintenance

WARNING

Before opening the case, disconnect from the circuit and shut off the unit.

Failure to observe these warnings can result in severe injury or death.

Battery Replacement

1. Turn the unit off.
2. Disconnect the unit from the circuit.
3. Remove the battery compartment screws, then the back of the unit.
4. Replace the battery (observe polarity).
5. Replace the back and the screws.

Maintenance (cont.)

Tip Replacement

1. Turn the unit off.
2. Loosen the screw nearest the tip.
3. Pull on tip to remove.
4. Replace the tip and tighten the screw.

Cleaning

Periodically wipe with a damp cloth and mild detergent; do not use abrasive or solvents.

One-Year Limited Warranty

Progressive Electronics warrants to the original purchaser of these goods for use that these products will be free from defects in workmanship and material for one year, excepting normal wear and abuse.

For all Test Instrument repairs, you must first request a Return Authorization Number by contacting our Customer Service department at 800-528-8224. This number must be clearly marked on the shipping label. Ship units Freight Prepaid to Progressive Electronics, 325 South El Dorado, Mesa, Arizona, 85202 USA. Mark all packages: Attention TEST INSTRUMENT REPAIR.

For items not covered under warranty (such as dropped, abused, etc.) repair cost quote available upon request.

Note: Prior to returning any test instrument, please check to make sure batteries are fully charged.

Progressive Electronics
325 South El Dorado • Mesa, AZ 85202
480-966-2931 • 800-528-8224 • fax: 480-967-8602
www.progressive.textron.com